

1-800-398-5127

E-Z TONE®

AN ENTRY AND EXIT CHIME

5 YEAR WARRANTY

SPECIAL FEATURES

1. NO BATTERIES
2. NO ELECTRICITY
3. QUICK INSTALLATION
4. DO IT YOURSELF INSTALLATION
5. NO MAINTENANCE
6. SILENCER TO SHUT SOUND OFF
7. COLORS - BRONZE OR LIGHT GREY

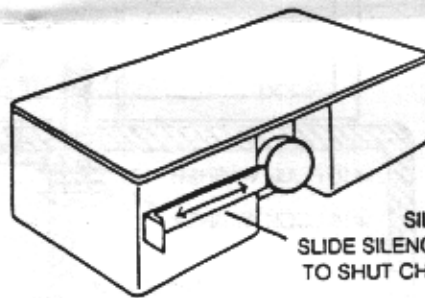

SILENCER
SLIDE SILENCER AS INDICATED
TO SHUT CHIME OFF AND ON.

PARTS LIST E-Z TONE CHIME

- | | |
|------------------------------|---|
| CH-1 - Shaft and Cup-1, Unit | CH-13 - Sounding Bar Grommet |
| CH-2 - Metal Disc. | CH-14 - #4 x 3/8" Screw for Lid |
| CH-3 - Magnet | CH-15 - #8 x 3/4" Truss Head Metal Screw for Mounting Chime Box and Metal Disc. |
| CH-4 - Short Spring | CH-16 - #10-24 x 1/2" Truss Head Bolt |
| CH-5 - Main Spring "Long" | CH-17 - #10 Lock Washer |
| CH-6 - #6 Plain Washer | CH-18 - #10 Plain Washer |
| CH-7 - "E" Spring | CH-19 - #10-24 Keps Nut |
| CH-8 - Striker Pin | CH-20 - Drill Bit #29 |
| CH-9 - Chime Box Lid | CH-21 - Silencer |
| CH-10 - Chime Box | CH-22 - Grommet Pin |
| CH-11 - Bracket | CH-23 - Retaining Ring |

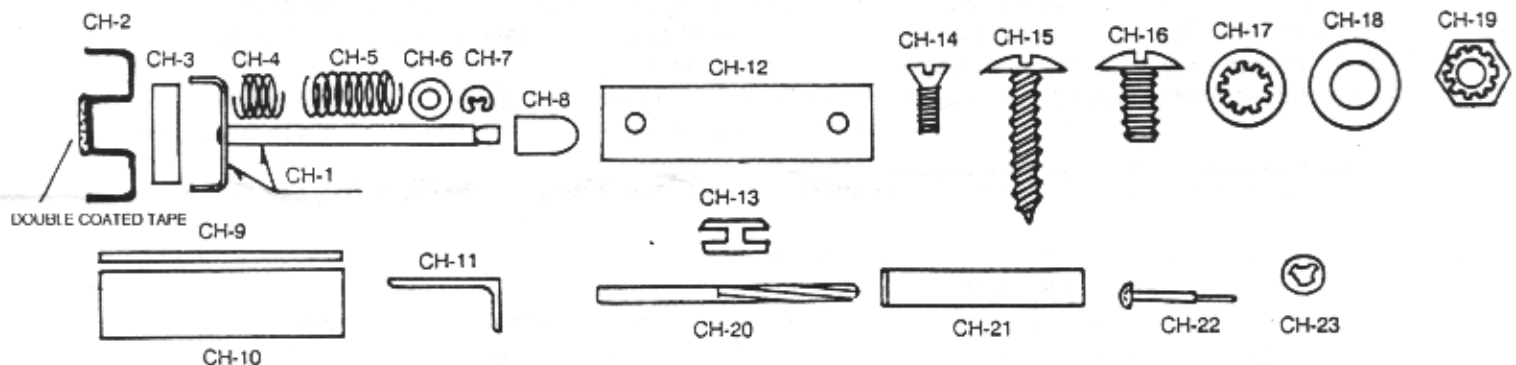

FULL SIZE DETAIL-SCREW, WASHERS AND NUTS ONLY